

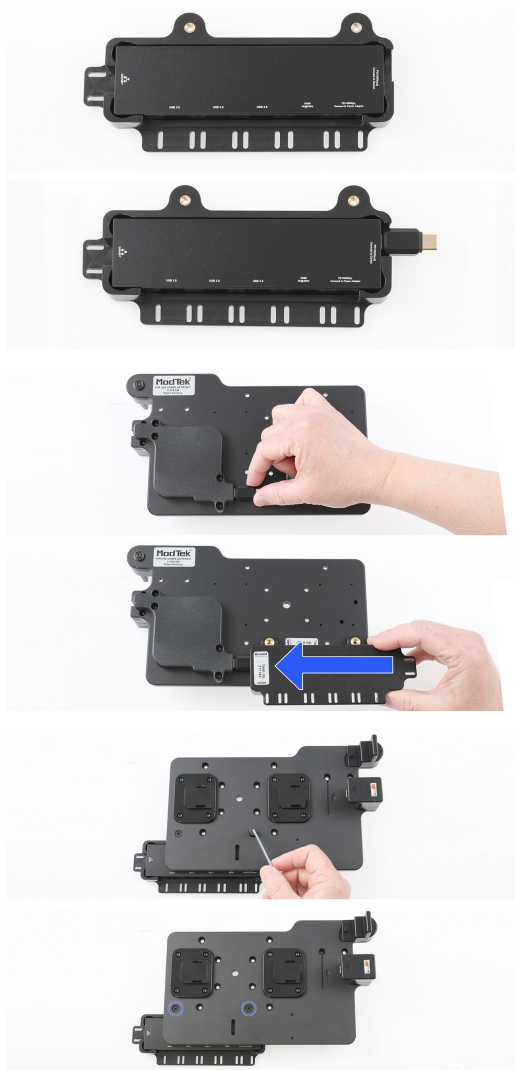

TELEPÍTÉS

Mount - Rögzítő



Please read all of the instructions and look at the pictures before attaching the module.

1. Hub and Cover: Before installing the hub, it needs to be inserted into the cover. Ensure the hub ports align with the cable retention slots as shown in the pictures. The included USB-C male to male adapter included is used to connect the hub directly to the back of the USB-C 3.1 dock.

2. Slide the hub and cover onto back of the dock ensuring the USB-C adapter engages into the hub and secures it.

3. Secure the Hub: Using the included fasteners and tool, secure the hub cover to the dock.

4. The holder and hub is in place.

Az alábbiakkal kompatibilis

