

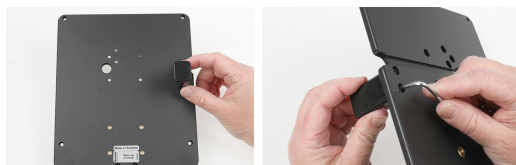

TELEPÍTÉS

Mount - Rögzítő



Please read all instructions and review the illustrations carefully before installing the mount.

1. Attach one side support to the mount using the supplied screws. Attach the foam pads to the mount. Place the charging box underneath the side support. Ensure that the charging box is not positioned too close to the AMPS mounting holes.

2. Position the second side support to secure the charging box in place and fasten it with the supplied screws. Insert the cable tie into the slot and secure both the charging box and cables.

3. Place the printer on a flat surface with the rear side facing upward. Position the mount on the printer, aligning the mounting holes. Secure the mount to the printer using the four supplied screws.
For installation on a pedestal mount: Attach the pedestal mount top plate to the mount, then secure the printer onto the pedestal mount.

4. The mount is now installed, with the printer securely attached.

Az alábbiakkal kompatibilis

- Brother TD-4550DNWB