

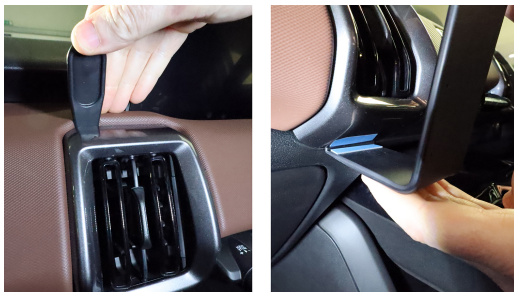

# TELEPÍTÉS

## ProClip



Please read all of the instructions and look at the pictures before attaching the ProClip mount. It is important to install the mount first: any device holder/equipment is to be attached after the mount is in place.



1. Press the thin end of the enclosed gap opener into the gap between the dashboard and the frame surrounding the air vent. Use the enclosed alcohol pad to clean the area where the mount will be installed. Peel off the adhesive tape cover. Hook the angled edge of the lower part of the mount under the frame surrounding the air vent.



2. Pull the mount upward and hook the angled upper edge into the gap next to the gap opener. Press down on top of the mount so the edge sits properly in the gap. Pull out the gap opener.



3. The mount can be installed on either center air vent.  
4. The ProClip mount is in place.

## Az alábbiakkal kompatibilis

- Suzuki E Vitara (2024-2026)