

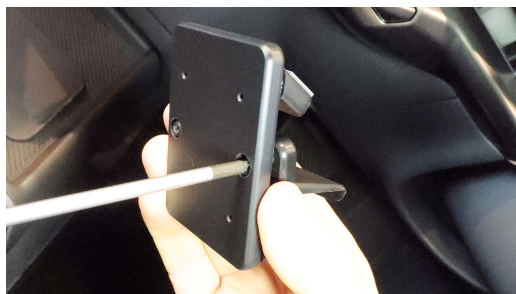

TELEPÍTÉS

ProClip



Please read all of the instructions and look at the pictures before attaching the ProClip mount. It is important to install the mount first: any device holder/equipment is to be attached after the mount is in place. This mount consists of two parts: A mount and a face plate.

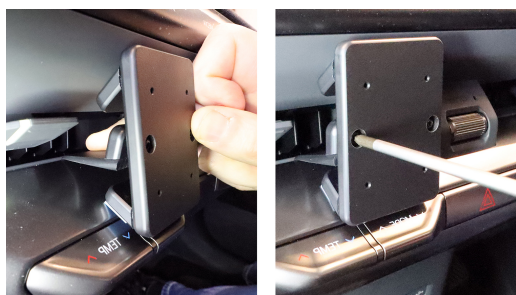

1. Place the mount behind the mounting plate as shown in the image and loosely fasten them together using the included screws. Use the enclosed alcohol pad to clean the area where the mount will be installed. Peel off the adhesive tape cover.



2. Hook the angled edge of the mount over the frame surrounding the air vent. Carefully tighten the screws in the mounting plate until the mount feels securely in place.



3. The mount can be positioned anywhere within the width of the air vent.

4. The ProClip mount is in place.

Az alábbiakkal kompatibilis

- Kia EV2 (2027)